

Characteristics

FKOV250

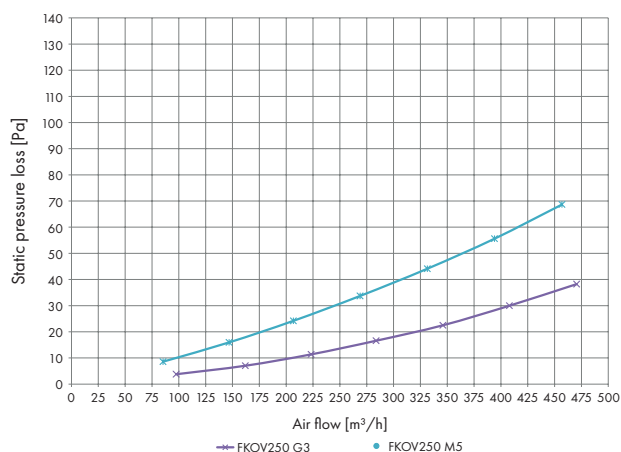

FKOV315

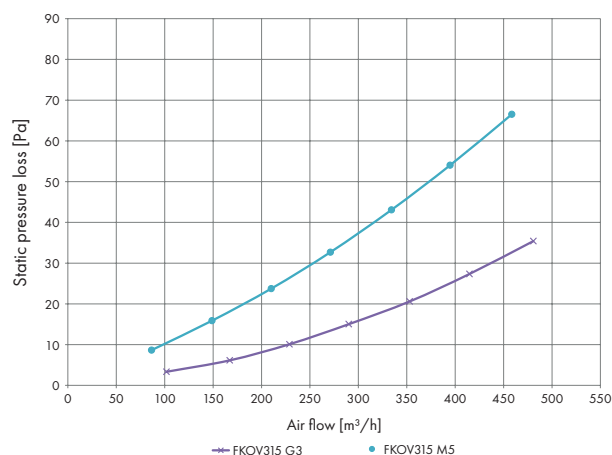

Access door for rectangular ducts VFAD

Description

The "VFAD" access door is equipped with a polythene gasket. It is designed for assembly in rectangular ducts. Made of galvanised steel. The set includes a template facilitating hole cutting.

Technical drawing

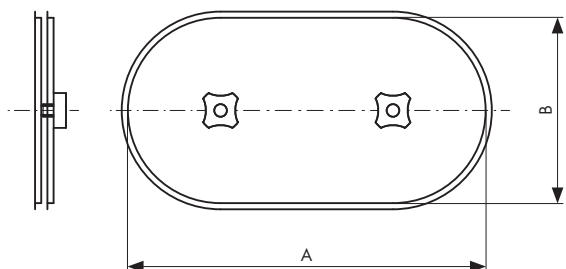

Dimensions [mm]

Model	A	B
VFAD 180x80	180	80
VFAD 200x100	200	100
VFAD 250x150	250	150
VFAD 300x200	300	200
VFAD 400x200	400	200
VFAD 400x300	400	300
VFAD 500x400	500	400