

Duct fans ICMsilent



Exceptionally
quiet operation



High
pressure



Two-speed

Design

Duct fan, diagonal. Its unique design ensures low noise emissions by using a perforated interior cover and a double layer of sound-absorbing material. The fan cover is made of polypropylene, while the rotor is made of ABS plastic. The unit is equipped with an integrated return damper. Special connectors make it easy to install, remove and maintain the appliance. The fan can be installed both horizontally and vertically.

Usage

The ICMsilent fan is designed to transport clean air. Ideal for installation of general ventilation of public buildings, conference rooms, offices, restaurants, hotels, school rooms.

Electric motor

Two-speed motor, powered by single-phase current 230V, 50Hz. Suitable for voltage regulation. Protection class IP 44, insulation class B. The motor is equipped with durable ball bearings and thermal protection of the winding against overload.

Operating temperature

The fan is designed to transmit air with a temperature not exceeding 60°C.



Dynamically balanced
diagonal rotor

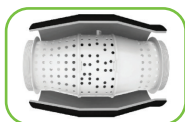

Original cover design - using
perforated interior and double-layer
sound-absorbing material



Special connectors facili-
tate device installation



Integrated return
damper

Technical specifications

Model	Speed	Air flow [m³/h]	Impeller speed [rpm]	Power [W]	Current [A]	Voltage [V]	Frequency [Hz]	Sound pressure level [dB(A)]	Weight [kg]	Switch HRS	Controller HRX	Controller HRB
ICMsilent-100-125/290M	HS	284	2250	33	0,14	230	50	29	2,8	Yes	1,0	1,5
	LS	248	1850	28	0,13			24				
ICMsilent-150-160/530M	HS	530	2550	50	0,25	230	50	31	4,0	Yes	1,0	1,5
	LS	410	1850	43	0,20			26				
ICMsilent-200/840M	HS	840	2550	128	0,57	230	50	37	4,5	Yes	1,0	1,5
	LS	690	1950	123	0,52			32				

Sound pressure level measured at 3m.

Technical drawing

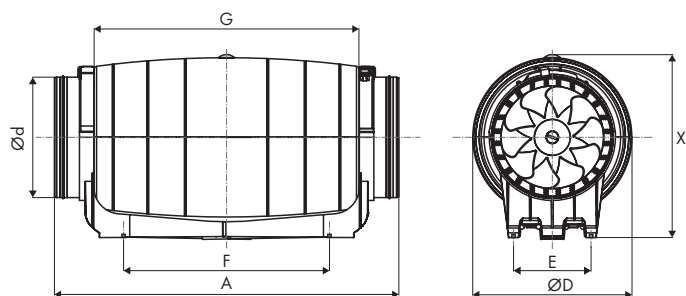

Dimensions [mm]

Model	X	A	ØD	Ød	E	F	G
ICMsilent-100-125/290M	225	580/462	204	97/123	82	248	330
ICMsilent-150-160/530M	244	488	221	148/158	95	251	352
ICMsilent-200/840M	301	567	262	198	128	339	436

Characteristics

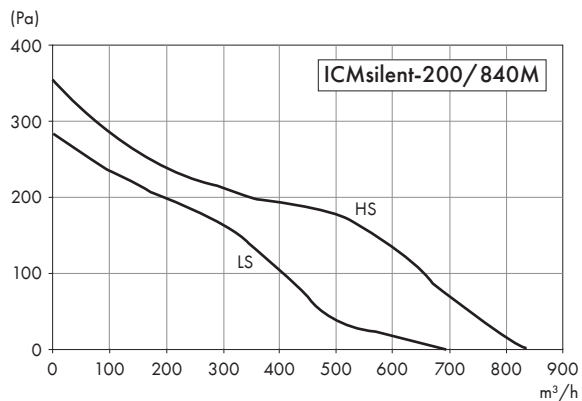
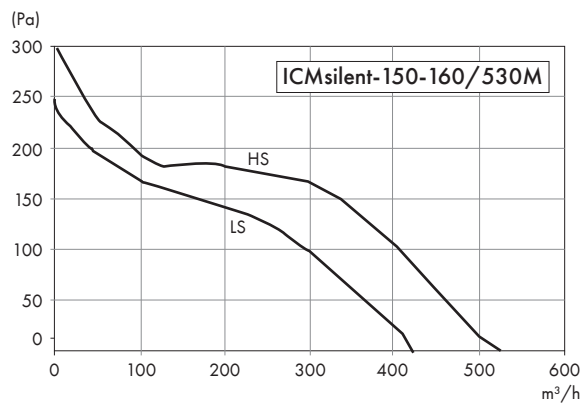
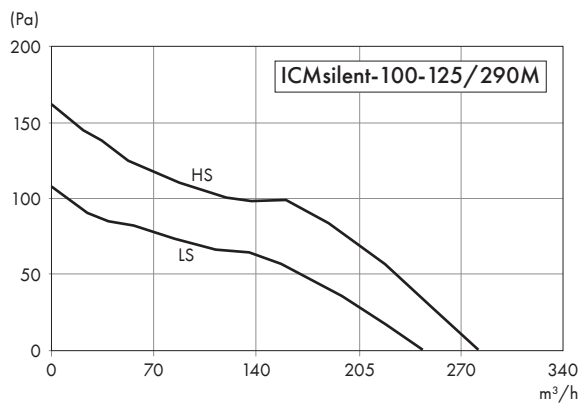

Accessories



HRS
Single-phase motor gear switch
page 175



HRB
Transformer speed controller
page 176



PSH
Pressure switch
page 173



PCC
Fastening clamp
page 81



HRX
Electronic speed controller
page 174



FKOV
Filter G3 for round ducts
page 83



AKUFLEX
Flexible acoustic silencer
page 71



WSH
Service switch
page 177